

Contents

1 Principles of Operation	2
1.1 SIRT-AR Bolt Operation	2
1.2 Dry Firing	2
1.3 On Range Practice	3
1.4 Consideration of Others When Dry Firing	3
2 Installation and Adjustment Procedures	3
2.1 Installation Instructions	3
2.2 Linkage Adjustment	5
2.3 Laser Adjustment	5
2.4 Battery Replacement	5
3 Trouble Shooting Tips	6
4 Warranty Information	7
4.1 Next Level Training AR-Bolt Warranty	7
4.2 NLT Return Instructions	8
5 General Training	8
5.1 General Training Methods	8

Principles of Operation

1.1 SIRT-AR Bolt Operation

- Pick up the rifle.
- Establish a solid grip.
- Identify target.
- Prep the trigger and break a shot.

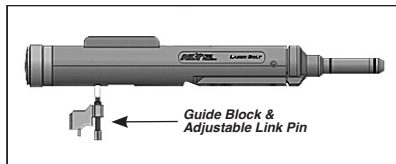

Figure A: SIRT-AR Bolt

The SIRT-AR Bolt system accurately recreates real world training experience for the M4 and AR platforms using the Shot Indicating, Resetting Trigger (SIRT) technology. This laser-based dry-fire training tool will dramatically enhance rifle skill development through the resetting trigger, rather than the need to rack the bolt between shots.

Parts included:

- AR-Bolt
- Adjustable Link Pin
- Lower Receiver Guide Block.
- Laser Adjustment Tool.
- Owners Manual.
- Ruggedized Carrying Case

1.2 Dry Firing

1. ALWAYS keep the gun pointed in a safe direction.
2. ALWAYS keep your finger off the trigger until ready to shoot.
3. ALWAYS keep the gun unloaded until ready to use.
4. ALWAYS be aware of your target and what's behind it.

Please follow all basic principle rules regarding dry firing practice. The SIRT-AR Bolt is an inert unit and cannot fire a real round. However, the SIRT-AR Bolt emulates the functional features of the real firearm for the most beneficial training effects. When dry firing, do not have a loaded, real rifle in the vicinity, or any ammunition.

When dry firing off of the range be sure to clear the room/area of ALL ammunition even when only dry firing with the SIRT-AR Bolt.

If dry firing in conjunction with your live fire rifle a safety check of all firearms MUST be conducted. Open the action, look and feel the magazine well and chamber.

1.3 On Range Practice

When on the range, it is beneficial to train trigger mechanics with the SIRT-AR Bolt in between live fire drills. In this environment, treat the SIRT-AR Bolt as a real rifle, and follow the four basic rules at all times. Again, we cannot over emphasize the importance of treating the SIRT-AR Bolt like a real firearm.

1.4 Consideration of Others When Dry Firing

Be sure any individual that may be watching you when dry firing is aware that you are engaged in dry fire practice. Although the SIRT-AR Bolt has cosmetic and color distinctions, your overall body movements and the general functional shape with the SIRT-AR Bolt will give the potential appearance of firing a rifle. Although the SIRT-AR Bolt is extremely conducive to training in many areas and opens up opportunities to train in various situations, use extreme discretion when handling the SIRT-AR Bolt and be aware of potential observers. Other considerations may apply:

- Be aware of any local or state laws that may be applicable.
- Please follow all basic principle rules regarding dry firing practice. The SIRT-AR Bolt will render your rifle inert. However, the SIRT-AR Bolt emulates the functional features of real firearms for the most beneficial training effects. When dry firing, do not have a loaded, real rifle in the vicinity, or any ammunition.

Installation and Adjustment Procedures

2.1 Installing your SIRT-AR Bolt

Customers can find an installation video here: www.nextleveltraining.com/sirt_arbolt_install

The SIRT-AR Bolt is designed to fit Mil Spec AR platforms. The SIRT-AR Bolt is designed to replace your weapon's bolt carrier group and charging handle.

- Remove any magazine in the AR and properly clear your rifle prior to installing the SIRT-AR Bolt.
- Unlatch the rear take down pin and open the rifle
- Using the charging handle slide the bolt carrier group out of the upper and set both components aside.



Figure B

Note: Before proceeding ensure there is no round in the chamber and the weapon is

in a safe condition.

- Insert the AR-Bolt SIRT in the upper receiver in place of the bolt carrier group. (Figure B) The two fins should align in the slot previously occupied by the charging handle. When properly seated the SIRT-AR Bolt should fit flush against the rear portion of the upper. (Figure C)



Figure C

Note: DO NOT use excessive force to insert the AR-Bolt SIRT. If there is a fitment issue please contact NLT customer service 360-933-4640.

Guide Block and Link Pin

Assemble the Guide Block and Link pin as shown (Figure D):

Insert the adjustable link pin onto the trigger bar next to the selector shaft (see Figure E). The adjustable link pin comes with a trigger foot piece that is designed to straddle the trigger bar or disconnect to ensure a positive contact.

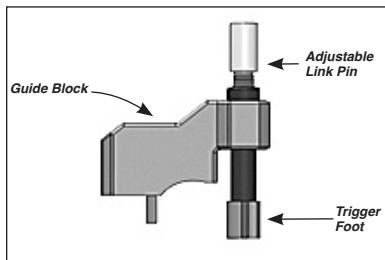

Figure D

Note: The foot can be trimmed to accommodate different trigger bar configurations. With the foot in place the pin must stand vertically against the selector shaft. There is a magnetic coupling to aid in aligning the guide block to the selector switch.

(Figure F)

- Carefully close the upper watching to make sure the link pin seats into the socket in the SIRT-AR Bolt (see Figure G)
- Before latching the upper to the lower pull the trigger and check to see if the laser is illuminating down the barrel. When the trigger is pulled you should hear an audible click at the break. If you are not hearing the click or not seeing the laser illuminate, adjustable link pin will need to be lengthened. Do this by unscrewing the pin until the desired length has been achieved.

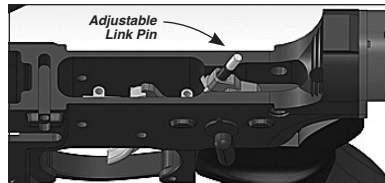

Figure E

Note: the initial setup may take a couple of adjustments.

2.2 Linkage Adjustment

The link pins (and guide block) are designed to work in a Mil Spec lower receiver with a standard trigger group. However, both are adjustable and conformable to fit a variety of AR platforms

- The link pin is adjustable in length by simply turning it.
- The red plastic of the link pin assembly can be cut and formed to better fit your trigger assembly.

2.3 Laser Adjustment

- Windage is adjusted using the set screw located through the ejection port cover. By turning the setscrew clockwise the shot indication should move to the right. (Figure I)
- Elevation is adjusted using the set screw located through the magazine well area. By turning the setscrew clockwise the shot indication should move down. (Figure J)

Note: It may take several combinations of adjustment to correctly align the laser.

2.4 Battery Replacement

The battery is located in the rear of the SIRT-AR Bolt.

- Remove the quick disconnect plastic end cap by twisting to unlock and then pulling straight off.
- The battery should simply be removed and a fresh battery inserted in the cavity. (Battery size is CR 123, can be

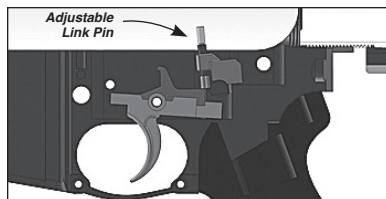

Figure F

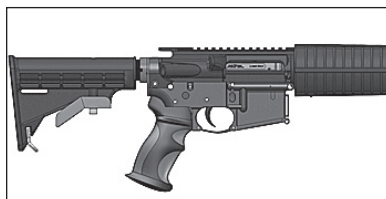

Figure G

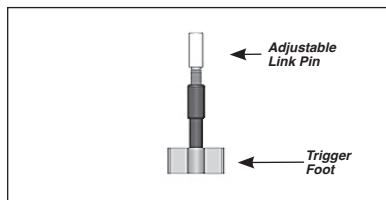

Figure H

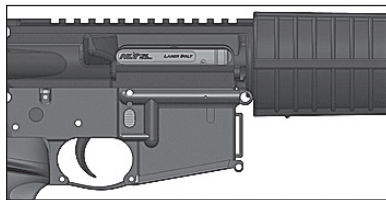

Figure I

purchased at www.nextleveltraining.com/product/sirt-SIRT-AR Bolt-battery)

- When reinstalling the end cap, align the notches with the posts on the housing and push into place. (Figure K)
- Fully seat the end cap by gently twisting until it locks into place. This will ensure a positive contact of the battery spring to the metal contact on the housing.

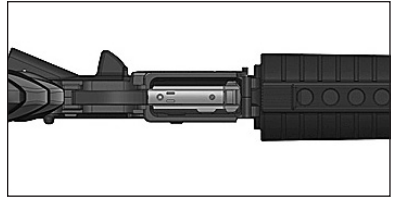

Figure J

Trouble Shooting Tips

- **Setting the Link Pin Adjustment:**
In the event the laser switch is not activating, first check the adjustment and placement of the Link Pin. The Link Pin is designed to be held by the guide block so that it rests on the right side rear portion of the Trigger Bar. The Guide Block is designed to position the Link Pin near the selector lever so that the pin remains vertical when traveling during trigger manipulation. Check that it is positioned properly by carefully opening the upper and watching the location of the Link Pin as it engages the SIRT-AR Bolt housing. Adjust the length of the pin until there is an audible click heard when operating the trigger with the complete SIRT-AR Bolt.
- **Aiming the Laser:** If the laser adjustment screws don't appear to be moving the laser, back the adjuster screws out and start the adjustment over. Note that when the laser is adjusted correctly, straight down the bore, there will be no distortion of the laser dot on the target. There is a small amount of elevation and windage adjustment to co-witness the laser to your sights at various ranges. Please keep in mind that at close ranges, due to the offset of

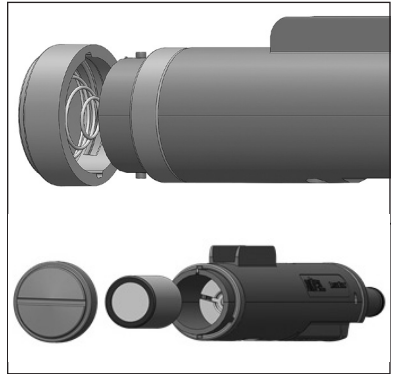

Figure K

most iron and optic sites, the shot indication could be obscured by obstacles in line with the barrel (such as cover) just as it would with an actual AR round.

- **Removing the SIRT-AR Bolt from your Upper:** The SIRT-AR Bolt is designed to fit into Mil Spec AR upper. If, when installed in your upper, the fit is so tight that you have to apply force to get the SIRT-AR Bolt in place, that means there is a fit problem, and we advise that you not put it into your upper until the fit issue has been resolved. In the event you jam a SIRT-AR Bolt into your upper, you can use the link pin inserted into the hole in the SIRT-AR Bolt housing as a bearing point to pull it out. If needed, use a soft material, such as brass or plastic, driven with a small hammer to drive against the pin to loosen the SIRT-AR Bolt.
- **Laser Sticking On:** The likely cause for this is that the link pin is set too long and will need to be shortened. Open the AR and adjust the link pin per the instructions in this manual (Page 5, Section 2.2.) If that does not correct the problem, there is likely an internal failure of the components.

Warranty Information

4.1 Next Level Training AR-Bolt Warranty

Subject to the terms, conditions and exclusions set forth below, NextLevel Training, LLC (hereinafter NLT), hereby expressly warrants solely to the original consumer purchaser of this training SIRT-AR Bolt, that the SIRT-AR Bolt is free from defects in workmanship and in materials for a period of 90 days from date of purchase by the original consumer purchaser. Any implied warranty, including warranty of merchantability or of fitness for a particular purpose, is limited to the same period of one year from the date of purchase by the original purchaser.

During the warranty period, NLT will, at its option, repair or replace without charge the training SIRT-AR Bolt when an authorized NLT service representative determines it is defective in workmanship or materials.

The provisions of the warranty shall not apply to any training SIRT-AR Bolt which has been subject to misuse, negligence alteration, use of non-authorized spare parts, improper maintenance, or removal, alteration or defacing of any serial numbers, or dismantling further than described in the Manual. Nor shall the warranty apply if the training SIRT-AR Bolt is damaged by fire, flood, accidents, acts of God or any other similar causes beyond NLT's control.

In no event shall NLT be liable for damages or loss of use, loss of business or profits or for



any other incidental or consequential damages.

No dealer or other person has the authority orally to vary the terms, conditions or exclusions of this warranty, or make any other express warranties than those contained herein.

This warranty gives the original consumer purchaser specific legal rights. The original consumer purchaser may also have other rights which vary from state to state.

4.2 NLT Return Instructions

In the event SIRT AR Bolt requires work or replacement please contact Next Level Training Customer Service at 360-933-4640.

General Training

5.1 General Training Methods

The SIRT-AR Bolt is designed to allow the user the full benefit of training, maximizing performance aspects and diagnostics in the greatest time and cost effective manner possible.

It is NLT's ultimate goal to aid end users, whether competition shooters, hunters, tactical operators, instructors, beginner, or advanced shooters, to hone their skills with the AR Platform in a safe effective manner while providing the greatest feed back and improvement in skills.

The SIRT-AR Bolt allows basic users to focus on fundamentals of marksmanship and provides easy progression into more advanced performance shooting. Intermediate to advance shooters can then focus on footwork, target transition, indexing, dynamic movement drills and more with positive hit confirmation and target acquisition.

NLT has worked to perfect products and training that incorporate these skills at all levels. Visit www.nextleveltraining.com to view training videos (for all skill levels) or sign-up to attend an NLT live training course

***NOTE: Safety is an inherent concern in all training scenarios.
Train Hard. Train Smart.***